

3D MODEL ONLY



Toilet paper tube to container kit



Makidev

[VIEW IN BROWSER](#)

updated 16. 2. 2024 | published 16. 2. 2024

Summary

This is a kit to convert toilet paper tubes into little containers.

[Hobby & Makers](#) > [Organizers](#)

Tags: [organiser](#) [container](#) [paper](#) [toilet](#) [tube](#) [roll](#) [crafts](#)
[crafting](#)

There is now an improved version of this model that does not require prying the lid open with a tool: <https://www.printables.com/model/766096-improved-toilet-paper-to-containet-kit>

This is a kit to convert toilet paper tubes into little containers. The lid is print in place, but you will initially need to pry it open using a flat tool.

Summary of the versions:

- “regular” files: Designed for tubes with an inner diameter of approximatly 41.6mm (Canada and probably others)
- “smaller” files: Designed for tubes with an inner diameter of approximatly 38 mm (Australia and probably others)

Also included:

- A version of the lid without a cap

- A connector to join multiple tubes together

NOTE: It is designed for a layer height of 0,2mm.



Print settings:

Resolution : 0.2mm

Infill : 15%

Material : PLA

Supports: No

Updates:

2024-01-21: New version of the lid (v2). Bigger hinge with more clearance.

2024-01-21: New version of the lid (v3). To prevent the inner walls from fusing together, the diameter of the innermost wall was reduced in order to increase the clearance. v3a has a reduced diameter of 0.4mm (so 0.2mm clearance added all around) and the v3b has a reduced diameter of 0.8mm (so 0.4mm clearance added all around). The closest these walls are from each other, the better the lid will close (and stay closed), so stick with the v2 if it works for you.

2024-01-21: Since the v3a seemed to be the best overall, I got rid of the v1, v2 and v3b and renamed files for simplicity. Regular files should fit most

american rolls (41.6mm inner diameter) and the smaller files could fit
Australian rolls (38mm inner diameter)

Model files

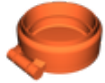

regular_lid416mm.stl

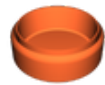

regular_bottom416mm.stl



regular_no-cap_lid416mm.stl

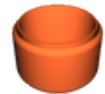

regular_connector416mm.stl

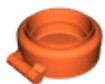

smaller_lid38mm.stl

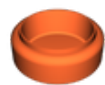

smaller_bottom38mm.stl



smaller_no-cap_lid38mm.stl

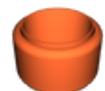

smaller_connector38mm.stl

License

This work is licensed under a
Creative Commons (4.0 International License)



Attribution-NonCommercial

- ✗ | Sharing without ATTRIBUTION
- ✓ | Remix Culture allowed
- ✗ | Commercial Use
- ✗ | Free Cultural Works
- ✗ | Meets Open Definition