



## Coleman RoadTrip 285 Replacement foot



Rflewelling

[VIEW IN BROWSER](#)

updated 28. 1. 2024 | published 28. 1. 2024

### Summary

One of the feet on my RoadTrip grill broke so I printed replacements!

[Household](#) > [Outdoor & Garden](#)

Tags: [grill](#) [roadtrip](#) [coleman](#) [285](#)

Original on the left, replacement on the right.

One of the feet on my Coleman RoadTrip 285 broke. I wasn't able to source a replacement so I quickly designed and printed a replacement.

Printed at 40% cubic infill with Elegoo ASA for UV/Temperature resistance, and durability. I've not field-tested it yet, only fitment and standing up the grill. You may need to increase infill.

.28mm Height with variable layers at +/- .2mm

**Printed on a raft with supports** at 60 degrees. Supports were easily removed. Printed hole-down so it wouldn't split when slipping it onto the bar. It was not an extremely tight fit. YMMV.

# Model files

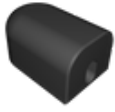

**coleman-stove-foot-v1.3mf**

☐ Print in current orientation

## License

This work is licensed under a  
[Creative Commons \(4.0 International License\)](#)



### Attribution

---

- ✗ | Sharing without ATTRIBUTION
- ✓ | Remix Culture allowed
- ✓ | Commercial Use
- ✓ | Free Cultural Works
- ✓ | Meets Open Definition