



## Balance board



Patrik Rosén

[VIEW IN BROWSER](#)

updated 28. 1. 2024 | published 28. 1. 2024

## Summary

I created a balance board for my indoor SUP training during winters

[Sports & Outdoor](#) > [Indoor Sports](#)

Tags: [balance](#) [balanceboard](#) [standuppaddleboard](#)  
[standuppaddle](#)

A balance board to get some instability while doing indoor SUP during the winters.

Needed to assemble is a threaded rod, nuts and elastic cord.

## Model files

**balance.stl**



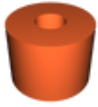

balance\_distance.stl

## License ©

This work is licensed under a  
[Creative Commons \(4.0 International License\)](#)



**Attribution—Noncommercial—No Derivatives**

---

- ✗ | Sharing without ATTRIBUTION
- ✗ | Remix Culture allowed
- ✗ | Commercial Use
- ✗ | Free Cultural Works
- ✗ | Meets Open Definition