

Arduino Nano Terminal Adapter



JAPOLabs

[VIEW IN BROWSER](#)

updated 19. 8. 2021 | published 19. 8. 2021

Summary

Support/adapter for this popular Arduino Nano Terminal (As shown in the photo).

[Hobby & Makers](#) > [Electronics](#)

Tags: [arduino](#) [adapter](#) [arduinonano](#) [nano](#) [arduinonanocase](#)

This design allows you to attach an Arduino Nano through the popular Deek-Robot Nano Terminal Adapter in a more robust fashion to your projects.

It allows a pretty degree of stability in front of movements and vibrations with 4 attachment holes and anchors for cable ties.

For best results, remember to keep your printer well calibrated and your slicer well optimized, specially in terms of dimensional accuracy.

Cheers!

Model files

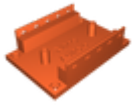

arduino-nano-adapter-holder.stl

License

This work is licensed under a
[Creative Commons \(4.0 International License\)](#)



Attribution

- ✗ | Sharing without ATTRIBUTION
- ✓ | Remix Culture allowed
- ✓ | Commercial Use
- ✓ | Free Cultural Works
- ✓ | Meets Open Definition