

## Center Find Tool



[schiffer-soft.de](#)

[VIEW IN BROWSER](#)

updated 12. 4. 2022 | published 21. 10. 2019

## Summary

Hi For a new project I needed a way to find the center of many different cylinders very cleanly.

[Hobby & Makers](#) > [Tools](#)

Tags: [prusa](#) [tool](#) [center](#) [cylinder](#) [prusai3mk3](#)  
[centerfinder](#) [cylindrical](#)

Hi

For a new project I needed a way to find the center of many different cylinders very cleanly. With the center search tool you can now easily find the center by multiple markers.

For the assembly 3.0 x 10mm screws are required.

### ALSO INTERESTING



## Happy printing

MFG

Chris

Follow me on...

[prusaprinters.org](https://prusaprinters.org)

 [thingiverse](https://thingiverse.com)

 [Instagram](https://www.instagram.com)

If you like it ;) - Thx for me!

 [www.paypal.me/schiffersoft](https://www.paypal.me/schiffersoft)

## Print instructions

**Printer Brand:** Prusa

**Printer:** i3 MK3 MMU 2

**Resolution:** 0.15

**Infill:** 30% or more

**Filament:** dasFilament PLA Tom's Blue

## Model files

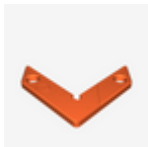

**centerfinder01\_7422.stl**

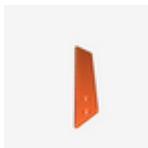

**centerfinder02\_7422.stl**



**centerfinder02.stl**

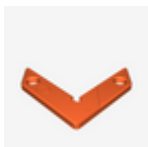

**centerfinder01.stl**

[Find source .stl files on Thingiverse.com](https://thingiverse.com)

# License ©

This work is licensed under a  
**Creative Commons (4.0 International License)**



## **Attribution-NonCommercial**

---

- ✗ | Sharing without ATTRIBUTION
- ✓ | Remix Culture allowed
- ✗ | Commercial Use
- ✗ | Free Cultural Works
- ✗ | Meets Open Definition