



## IKEA Helmer drawer insets (Updated)



Tor

[VIEW IN BROWSER](#)

updated 8. 12. 2019 | published 21. 10. 2019

### Summary

Update 08/12 new thinner design for faster printing. Included 3mf files for cube and rectangle.



7.44 hrs



1 pcs



0.20 mm



0.40 mm



PLA



104 g



Prusa  
MK3/S/S+

[Household](#) > [Office](#)

Tags: [ikea](#) [container](#) [cube](#) [organization](#) [drawer](#) [inset](#)  
[helmer](#)

### Update 08/12 new thinner design for faster printing.

Included 3mf files for cube and rectangle.  
Speed settings are tweaked for maximum speed without (that much) quality loss.

Simple insets that fit in Ikea Helmer drawer.  
The inner bottom corners are rounded so it's easier to grab stuff.

The back rectangle is meant to utilize the leftover space in the back of the drawer.

Also for those with a bigger printer, the big cube doesn't fit on a Prusa (yet).

## Print instructions

Because of the curved inside, the print needs infill to a point. I have used a modifier to block infill from 3mm and up.

See the uploaded 3mf-file.

### UPDATE

the new version doesn't need infill.

## Model files



**rectangle-4h-fast.3mf**

---



**cube-3h-fast.3mf**

---



**cube.stl**

---

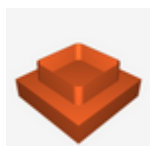

**ikea-cube.3mf**

---



**rectangle.stl**

---

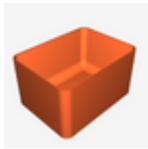

**back-rectangle.stl**

---



**clip.stl**

---



**rectangle-small.stl**

---



**rectangle-small-narrow.stl**

---

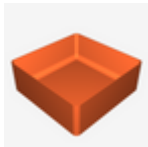

**cube-xl.stl**

---



**cube-v3.stl**

---



**rectangle-v3.stl**

---

## Print files



**ikea-cube\_02mm\_pla\_mk3s\_7h26m.gcode**

🌀 PLA   🌀 0.40 mm   ≡ 0.20 mm   ⌚ 7.44 hrs   ⚖️ 104 g   🖨️ Prusa MK3/S/S+

# License

This work is licensed under a  
**Creative Commons (4.0 International License)**



**Attribution-ShareAlike**

---

- ✗ | Sharing without ATTRIBUTION
- ✓ | Remix Culture allowed
- ✓ | Commercial Use
- ✓ | Free Cultural Works
- ✓ | Meets Open Definition