



Raspberry Pi 5 PCIe NVMe Case for Pimoroni NVMe Base



jeepers01

[VIEW IN BROWSER](#)

updated 2. 5. 2024 | published 2. 5. 2024

Summary

The case has been designed to house the Pimoroni NVMe Base mounted under the Pi

[Gadgets](#) > [Computers](#)

Raspberry Pi 5 PCIe NVMe Case for Pimoroni NVMe Base

The case has been designed to house the Pimoroni NVMe Base mounted under the Pi.

Four mounting posts are provided to mount the Pi on top and the Hat to the underside. These act as a spacers and are sandwiched between the two boards

8x M2.5mmx6mm screws self tap into the mounting posts, fixing the Pi and NVMe Base in position.
(these screws were included with the Base)

I found it easier to install the PCIe flex between the two boards and then fix to the posts.

The wall thickness of 2.5mm allows for a small reset button which sits in a small square guide recess.

(Printed in PLA 0.10mm to get good definition).

If the button is printed in transparent PLA it will be illuminated by the LED behind on the PCB.

Similarly a small lens can be printed in transparent PLA and inserted into the 2x2 LED hole.

The case is printed upright at 0.2mm PLA.

Supports being needed to the Pi mounting posts at each of the 4no. Pi / Hat fixing points.

****Update 08Feb24****

The Case body stl did not contain the hole for the push button for some reason.

Also a Case body is uploaded which contains an extra hole for the activity led.

Thanks to Jake for raising the issue and the request for the led hole.

New stl and stp files have been uploaded and are differentiated by either "No led hole" or "Inc led hole".

Also added picture showing holes and a picture showing cross section where the stacking of the two boards can be seen.

Hope the helps someone.

Model files

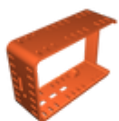

pi-5-pcie-nvme-case-body-no-led-hole.stl

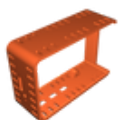

pi-5-pcie-nvme-case-body-inc-led-hole.stl



pi-5-pcie-nvme-case-top-cover.stl

pi_5_pcie_nvme_case_top_cover-_no_logov9.stl



pi-5-pcie-nvme-case-bottom-cover.stl



pi-5-pcie-nvme-button.stl

pi-5-pcie-nvme-case-body-inc-led-hole.step

pi-5-pcie-nvme-case-body-no-led-hole.step

pi-5-pcie-nvme-case-bottom-cover.step

pi-5-pcie-nvme-button.step

pi-5-pcie-nvme-case-top-cover.step

License ©

This work is licensed under a
[Creative Commons \(4.0 International License\)](https://creativecommons.org/licenses/by-nc-sa/4.0/)



Attribution—Noncommercial—Share Alike

- ✗ | Sharing without ATTRIBUTION
- ✓ | Remix Culture allowed
- ✗ | Commercial Use
- ✗ | Free Cultural Works
- ✗ | Meets Open Definition