



Time Chase Insert



vzom

[VIEW IN BROWSER](#)

updated 29. 1. 2024 | published 29. 1. 2024

Summary

An insert for Time Chase. Includes a removeable tray for fuel crystals. Supports sleeved cards.

[Toys & Games](#) > [Board Games](#)

Tags: [boardgames](#) [boardgame](#) [inserts](#) [insert](#)
[boardgameinserts](#) [boardgameinsert](#) [boardgameorganizer](#)
[gameorganizer](#) [boardgamesinlay](#) [boardgameinlay](#) [gameinsert](#)
[boardgameorganiser](#) [timechase](#) [gamesinsert](#) [gameorganiser](#)

This is a simple insert for Time Chase. It comes with a removable tray for the fuel crystals for easier access during the game.

The insert supports sleeved cards, though thin (non-premium) sleeves will need to be used. I used Mayday standard sleeves for my set, and there is only about 1mm of space to the top of the insert.

3 of the traveler pawns and corresponding control disks go in the space in the top right and the other 3 in the space in the bottom right. The 10 event tokens go between them, and there is a slot for the first player marker beneath the cards.

Model files

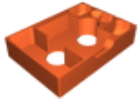

time-chase-insert.stl

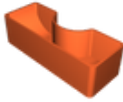

time-chase-crystal-tray.stl

License

This work is licensed under a
[Creative Commons \(4.0 International License\)](https://creativecommons.org/licenses/by-sa/4.0/)



Attribution-ShareAlike

-
- ✗ | Sharing without ATTRIBUTION
 - ✓ | Remix Culture allowed
 - ✓ | Commercial Use
 - ✓ | Free Cultural Works
 - ✓ | Meets Open Definition