



Box für Testkabelspule



MenschMeier

[VIEW IN BROWSER](#)

updated 29. 1. 2024 | published 29. 1. 2024

Summary

Dies ist eine Box für eine Testkabelspule welche man z.B. bei einem Installationstester verwendet.

[Hobby & Makers](#) > [Tools](#)

This remix is based on



Parametric Box - FreeCAD Edition

by Henry

Model files

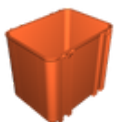

work1_parametric-box-boxbottom.stl



work1_parametric-box-leftlatch.stl

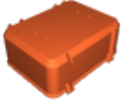

work1_parametric-box-boxlid.stl

License ©

This work is licensed under a
[Creative Commons \(4.0 International License\)](#)



Attribution

- ✗ | Sharing without ATTRIBUTION
- ✓ | Remix Culture allowed
- ✓ | Commercial Use
- ✓ | Free Cultural Works
- ✓ | Meets Open Definition