

Blaupunkt PA10 handle



Miha

[VIEW IN BROWSER](#)

updated 29. 1. 2024 | published 29. 1. 2024

Summary

The handle for the Blaupunkt PA10 speaker.

[Hobby & Makers](#) > [Mechanical Parts](#)

Tags: [handle](#) [speaker](#) [blaupunkt](#) [pa10](#) [blaupunktpa10](#)

This handle model is a replacement or upgrade for the Blaupunkt PA10 speaker.

Printer: Ender 3 V3 SE

Fillament used: PTEG

Slicer: PrusaSlicer

Supports: Organic

Infill: Gyroid 30%

To improve strength, modify the screw points to 100% infill.

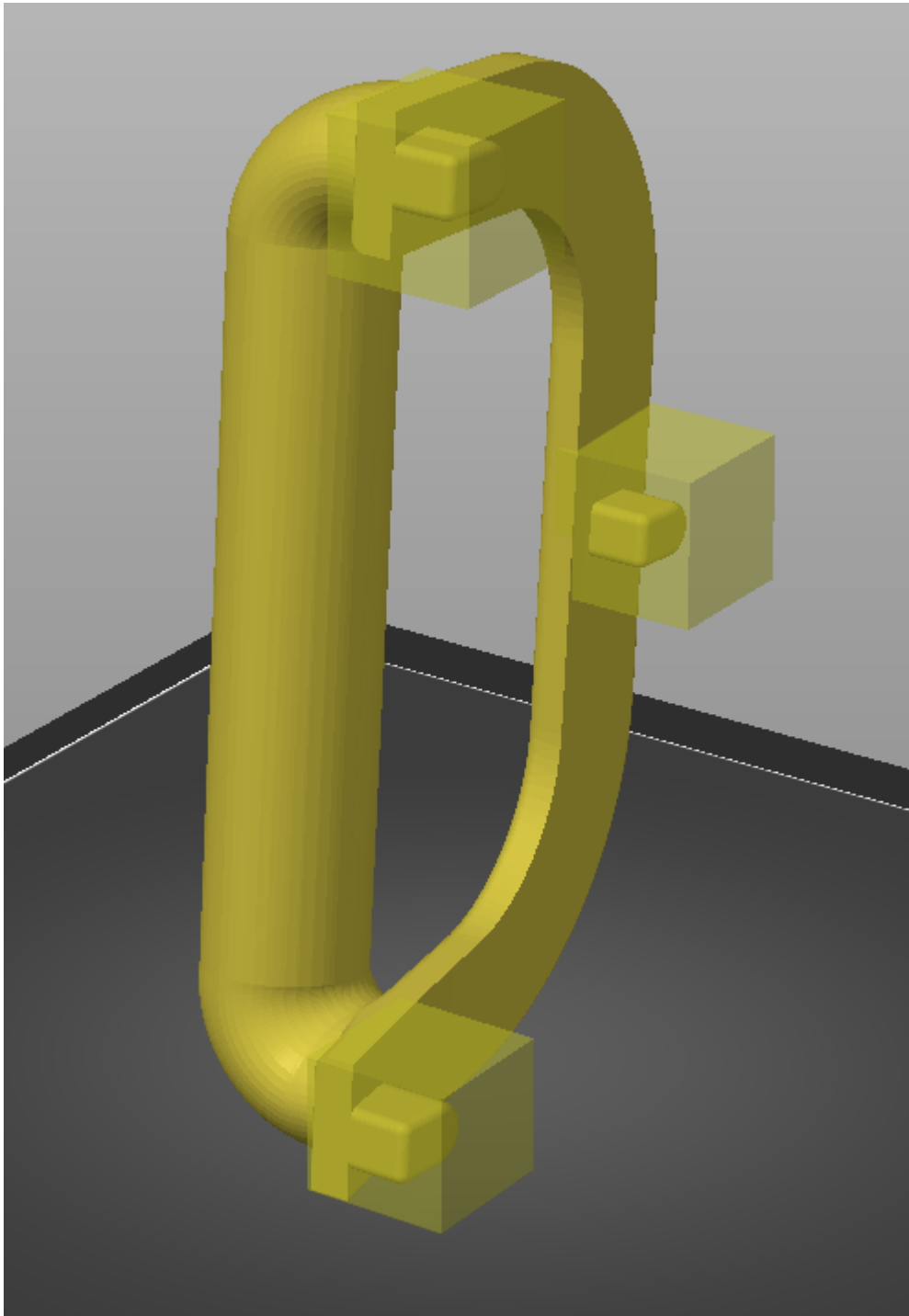

After printing, drill holes for the screws.

Model files



blaupunkt-pa10-handle.stl

License ©

This work is licensed under a
Creative Commons (4.0 International License)



Attribution

- ✗ | Sharing without ATTRIBUTION
- ✓ | Remix Culture allowed
- ✓ | Commercial Use
- ✓ | Free Cultural Works
- ✓ | Meets Open Definition