

3D MODEL ONLY

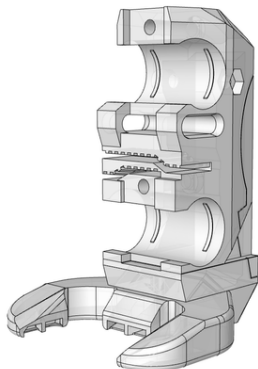

E3D V6 Hotend Fan Duct | Prusa MINI X-Carriage Replacement



the freewheeler

[VIEW IN BROWSER](#)

updated 13. 9. 2021 | published 28. 8. 2021

Summary

Rear-mounted fan duct for E3D V6 hotend. Replaces stock x-carriage on Prusa Mini. Also compatible with stock hotend.

[3D Printers](#) > [3D Printers - Upgrades](#)

Tags: [upgrade](#) [prusa](#) [mini](#) [original](#) [design](#) [mount](#) [e3d](#)
[hotend](#) [v6](#) [pinda](#) [fan](#) [adapter](#) [bearing](#) [cooling](#)
[bearings](#) [linear](#) [rod](#) [fanduct](#) [duct](#) [shroud](#) [carriage](#)
[bowdenhotend](#) [e3dhotend](#) [e3dv6](#) [fanmount](#) [fanshroud](#)
[sock](#) [remix](#) [airduct](#) [heatsink](#) [printerupgrade](#)
[hotendmount](#) [fancover](#) [upgrades](#) [originalprusa](#) [prusamini](#)
[linearbearing](#) [prusaupgrade](#) [coolingfan](#) [xcarriage](#) [3ddesign](#)
[coolingduct](#) [xaxiscarriage](#) [40mmfan](#) [rear](#) [e3dv6fan](#)
[grasshopper](#) [hotendcooling](#) [rhino](#) [partcooling](#) [e3dv6mount](#)
[rhinoceros](#) [threadedinsert](#) [pindaprotector](#) [siliconesock](#)
[partcoolingfan](#) [e3dv6clone](#) [product](#) [heatsinkthread](#)

threadedheatsink e3dcarriage mosquitohotend
printerupgrades originalprusamini e3dv6adapter
prusaminimod minda prusaminiupgrade partfanshroud
e3dhotendptfetube bearingcarriage spinda superpinda
rhino3d e3dfanshroud compacthotendshroud extrudershroud
compactshroud dragonhotend rearmounted

E3D Fan Duct Replacement

Rear-mounted x-carriage replacement fan duct for Prusa Mini/Mini+. Designed to improve part cooling with E3D hotend and heatblock, but will also work with stock hotend assembly.

Duct geometry is based on the [Mosquito Fan Shroud](#) by 4nthonylin. Please refer to his model for information regarding air flow analysis.

More info coming...

V6 Mount model will be uploaded and linked shortly. Until that time, please consider this part to be a work in progress.

Print in ABS, ASA, PC, or resin

For installation, simply reverse the [X Axis Assembly Instructions](#) or follow this [V3D Teardown](#)

Notes:

- Duct design eliminates the mounting hole for the PINDA holder. The stock PINDA mount will have to be replaced with a fan cover-integrated PINDA holder that is included in the V6 hotend mount assembly.
- If using duct with stock hotend, it's possible that you may need to raise the heatbreak several millimeters for proper clearance. Keep in mind that the tip of the nozzle should extend only ~1.5mm - 3mm below the bottom of the duct when fully assembled.
 - To do this, you'll need to remove the brass PTFE fitting, remove the short length of PTFE tube located inside the heatsink, and loosen the three grub screws on the side of the heatsink before raising to the proper height. Simply reverse these steps to reassemble.

08.30.2021

Super SPINDA mount replacement for stock hotend added. This replaces the stock SPINDA mount for the Mini and doubles as a fan cover. It threads directly into the existing threaded holes in the aluminum heatsink.

Fan Cover SPINDA Mount Hardware:

- (2) M3 x 25mm bolts
- (1) M3 x 12mm bolt
- (1) M3 threaded insert
 - Insert from the back side of the fan cover for securing SPINDA bolt
 - 4.0mm max depth
 - Suggest purchasing [from here](#)

09.13.2021

STL and STEP files for duct updated to reflect fan insert issue identified by @Ondřej H.

Tip Jar!

This remix is based on



Prusa Mini Mosquito Fan Shroud
by 4nthonylin

Model files



X-Carriage Duct

2 files



x-carriage_v6-duct.stl



x-carriage_v6-duct.stp



Stock Hotend Super PINDA Mount

1 file

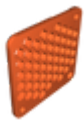

fan-cover_stock-spinda-mount.stl

☐ Compatible with stock heatsink ONLY!

License

This work is licensed under a
[Creative Commons \(4.0 International License\)](https://creativecommons.org/licenses/by-nc-sa/4.0/)



Attribution—Noncommercial—Share Alike

-
- ✗ | Sharing without ATTRIBUTION
 - ✓ | Remix Culture allowed
 - ✗ | Commercial Use
 - ✗ | Free Cultural Works
 - ✗ | Meets Open Definition