

MMU3 & MMU2S MK3S/+ & MK3.5 Extruder PTFE tube straightener chimney cover

 **tabbott916**

[VIEW IN BROWSER](#)

updated 18. 3. 2024 | published 18. 3. 2024

Summary

A simple chimney cap for the MK3S/+ & MK3.5 with MMU2S or MMU3 chimney that better aligns the extruder tubing.

[3D Printers](#) > [Prusa Parts & Upgrades](#)

Tags: [chimney](#) [mmu2s](#) [ptfeguide](#) [mk3smmu2s](#) [mmu3](#)
[mk3smmu3](#)

Prevent filament feed failures due to extruder PTFE tube misalignment when using the MMU2s or MMU3 with the MK3s/+ & MK3.5. This is a simple replacement chimney cover maintaining the stock geometry from Prusa while adding a filament guide and anti-rotation clip. This has completely eliminated my filament feed errors on both the MMU2s and MMU3 with the MK3s, MK3s+, and MK3.5 printers. I now run 70 hour + multi material prints with zero interventions.

This remix is based on



MMU3 printable parts

by Prusa Research

Model files

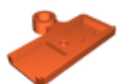

chimney-cover-with-tube-holder.stl

License

This work is licensed under a
GNU



General Public License v2.0

-
- ✗ | Sharing without ATTRIBUTION
 - ✓ | Remix Culture allowed
 - ✓ | Commercial Use
 - ✓ | Meets Open Definition
 - i | Share under the same license