



Why-Man from Dr. Stone

 RynRynnyRyn

[VIEW IN BROWSER](#)

updated 29. 1. 2024 | published 29. 1. 2024

Summary

The bottom part of Whyman. The top is a jar.

[Toys & Games](#) > [Action Figures & Statues](#)

Tags: [figurine](#) [medusa](#) [drstone](#) [whyman](#)

This is my first version of my Whyman model. I'm hoping to later update this to make it more dimensionally accurate and add a spot for an Arduino so that I hook it up to ChatGPT to make it speak.

For the glass part you have to use a 16oz canning jar. You take the rim part of the lid and glue it to the edge of the 3d printed part. You then paint and add details and then you are done.

Sorry if this is kinda low quality, I'm still new to 3d modeling.

Model files



medusa-bottom.3mf

☐ I recommend printing with at least 50% infill to offset the weight of the jar

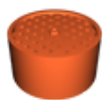

medusa-speaker.stl

☐ Scale to 1.08 size

License ©

This work is licensed under a
Creative Commons (4.0 International License)



Attribution-NonCommercial

- ✗ | Sharing without ATTRIBUTION
- ✓ | Remix Culture allowed
- ✗ | Commercial Use
- ✗ | Free Cultural Works
- ✗ | Meets Open Definition