



Nut and washer retaining brackets holders for mounting under benchtop

A AZMaker

[VIEW IN BROWSER](#)

updated 24. 2. 2024 | published 24. 2. 2024

Summary

Different shapes of retainers for nut and washer for 5/16 bolts. Screwed and/or glued to underside of bench top

[Hobby & Makers](#) > [Tools](#)

Tags: [nut](#) [bracket](#) [screw](#) [bolt](#) [bench](#) [vise](#) [retainer](#)
[washer](#)

Different shapes of retainers for holding a nut and washer for 5/16 bolts to the underside of my workbench. This allows me to remove the bolts holding my vise and later put them back in without having to remove drawers or use 2 sockets or wrenches to tighten them down. Appropriate length #6 screws hold them in place or you could glue them in place.

My settings:

0.4 nozzle, 0.2 layer, 40% infill, tree supports, ABS, 270/110, PEI or G10

Model files

nutwasherholder-4screws.stl



nutwasherholder-thin.stl

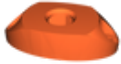

nutwasherholder-corners.stl



nutwasherholder-gapbridge.stl



License ©

This work is licensed under a
[Creative Commons \(4.0 International License\)](#)



Attribution-NonCommercial

- ✗ | Sharing without ATTRIBUTION
- ✓ | Remix Culture allowed
- ✗ | Commercial Use
- ✗ | Free Cultural Works
- ✗ | Meets Open Definition