

Syringe Whale



Chopcat Suey

[VIEW IN BROWSER](#)

updated 25. 2. 2024 | published 25. 2. 2024

Summary

A little syringe whale to play with in your bathtub.

[Toys & Games](#) > [Other Toys & Games](#)

Tags: [toy](#) [bathtub](#) [animal](#) [syringe](#) [wale](#)

This is a little syringe whale to play with in your bathtub. Push on the tail plunger to squirt water out of its blowhole.

Filament: Use a filament that doesn't immediately soften in warm bathtub water. PETG is probably fine. ASA could be preferable.

Printing: Orient the parts for printing as shown in the preview image. Print in the colors you want. Use some supports on the opening of the tail hole as shown in the preview image. For strong parts, print with a total wall thickness of ~2.5mm (4 perimeters with a 0.6mm nozzle).

Assembly: Glue the upper and lower body together. Glue the left and right fins to the lower body. Stick short segments of filament into the eye sockets as eyes. Insert the tail plunger into the body.

Model files

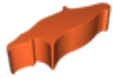

body-upper-meshed.stl



body-lower-meshed.stl



fin-le-meshed.stl



fin-ri-meshed.stl



tail-meshed.stl

License

This work is licensed under a
[Creative Commons \(4.0 International License\)](https://creativecommons.org/licenses/by-nc/4.0/)



Attribution-NonCommercial

- ✗ | Sharing without ATTRIBUTION
- ✓ | Remix Culture allowed
- ✗ | Commercial Use
- ✗ | Free Cultural Works
- ✗ | Meets Open Definition

