

## DIY Airboat



xadow

[VIEW IN BROWSER](#)

updated 12. 4. 2022 | published 4. 10. 2021

### Summary

I've been meaning to make a simple airboat for several years, in fact when I was younger I tried to build one...

[Hobby & Makers](#) > [RC & Robotics](#)

Tags: [reuse](#) [rc](#) [recycle](#) [steam](#) [diy](#) [engineering](#) [stem](#)  
[tvty](#) [science](#) [highschool](#) [makeitfloat](#) [airboat](#) [technology](#)

I've been meaning to make a simple airboat for several years, in fact when I was younger I tried to build one unfortunately I never got around the remote control part.

Bear in mind that this is still a work in progress.

20/07 - It works :-D. The direction mechanism needs some adjustments (fins, fins support, gear) to improve the turning radius, despite this it works rather well.

19/07 - Added revised versions for some of the parts. Some parts were a bit too flimsily and fixed some oversights. Currently printing the last part and assembling the airboat.

18/07 - Added a revised base version, should take less time to print and save a bit of filament. Also added support to the central arc.

I'm printing all of these parts with a E3D v6 with a .4 nozzle and PLA

You can get the propeller here: <http://www.thingiverse.com/thing:116974>

## Instructions

For this you will need two soda plastic bottles, I'm using two 1.5 liters bottles and a cheap rc car (I just bought the cheapest I could find, around 10€), tear it apart, you just need the eletrronics bit. Also a couple of zip ties (with diferent lengths), to secure everything.

Print two fins (fin.stl)

The base arcs require supports

Please print the latest versions of the parts (check for a \_v?.stl, where the ? should be biggest number available for that part)

Category: R/C Vehicles

## Model files

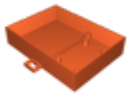

**case\_v2.stl**



**finssupport.stl**



**gearbox\_v2.stl**



**finssupport\_v2.stl**

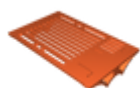

**base\_v3.stl**



**fin.stl**

---

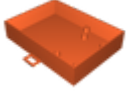

**case.stl**

---

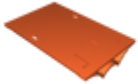

**base.stl**

---

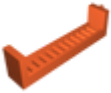

**gearbox.stl**

---



**gear.stl**

---



**enginesupport.stl**

---

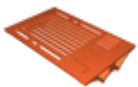

**base\_v2.stl**

---



**propellerimprovedfins.stl**

---



**connector\_v2.stl**

---



**connector.stl**

# License ©

This work is licensed under a  
**Creative Commons (4.0 International License)**



## **Attribution-ShareAlike**

---

- ✗ | Sharing without ATTRIBUTION
- ✓ | Remix Culture allowed
- ✓ | Commercial Use
- ✓ | Free Cultural Works
- ✓ | Meets Open Definition