

## COBRA Quick Release Mount



Teque5

[VIEW IN BROWSER](#)

updated 26. 11. 2021 | published 26. 11. 2021

### Summary

Allows wall-mounting of Tactipup Dog Collars or any harness using the COBRA Quick Release.

[Household](#) > [Pets](#)

Tags: [wall](#) [collar](#) [mount](#) [wallmount](#) [cobra](#) [tactipup](#)

Allows wall-mounting of [Tactipup Dog Collars](#) or any harness using the COBRA Quick Release. I could only chain about three collars together before they became too long to hang in a closet, so I just did two per mount.

### Design

The buckle design I reverse engineered from the physical copy. The wall mount design I slightly redesigned from [thing:4938923](#) by [MakerPhill](#).

### Printing

No supports. I printed with HTPLA+. I inserted a color change at 0.6mm to get the text to pop a bit. I also included a modifier with 100% infill on the weak parts.

## Installation

Each mount requires (1) flat head screw.

## Model files

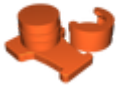

**2021-10\_cobra-buckle.3mf**

☐ Buckle and Wall Mount.

## License

This work is licensed under a  
[Creative Commons \(4.0 International License\)](https://creativecommons.org/licenses/by-sa/4.0/)



**Attribution-ShareAlike**

- 
- ✗ | Sharing without ATTRIBUTION
  - ✓ | Remix Culture allowed
  - ✓ | Commercial Use
  - ✓ | Free Cultural Works
  - ✓ | Meets Open Definition