

Doublecurve - Lego Duplo / Hubelino compatible



BamBam Design

[VIEW IN BROWSER](#)

updated 4. 6. 2024 | published 4. 6. 2024

Summary

Double-curve is an S-curved brick in different sizes for Hubelino® a marble run for Lego® Duplo®

[Toys & Games](#) > [Building Toys](#)

Tags: [duplo](#) [building](#) [lego](#) [marble](#) [marblerun](#)
[buildingblocks](#) [bricks](#) [kugelbahn](#) [hubelino](#)

Great **additional Doublecurve** set compatible to Hubelino® a Marble run for Lego® Duplo®.

Its for marbles around Ø25mm.

You can choose 3x3 and 4x4, each left and right direction

Did some optimization for better printing, like connected stud holes, thicker walls and after much test-prints i managed to get the clearance perfect. The bricks should fit like the other ones.

I printed with X1C in PLA+, you can try ABS & PET as well! Share your knowledge.

While testing get some warping, because of that i added a little brim.

Check out other Marble Bricks in my collection: [Patreon Link](#)

More Stuff is coming....Like & Subscribe ✓

I create only parts which are missing in the base set! The base parts you could buy #support Hubelino®, here is a affiliate link <https://amzn.to/3Rn1mES>

Happy printing 😊

Model files

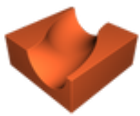

hubelino-compatible-double-curve-3x3l.stl

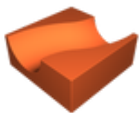

hubelino-compatible-double-curve-3x3r.stl

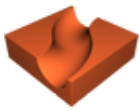

hubelino-compatible-double-curve-4x4l.stl



hubelino-compatible-double-curve-4x4r.stl

License ©

This work is licensed under a
[Creative Commons \(4.0 International License\)](#)



Attribution—Noncommercial—Share Alike

-
- ✗ | Sharing without ATTRIBUTION
 - ✓ | Remix Culture allowed

- ✖ | Commercial Use
- ✖ | Free Cultural Works
- ✖ | Meets Open Definition