

## Prusa XL series: Front Nozzle (For this nozzle brush, standard 175mm brass wire)

 **ninicrea**

[VIEW IN BROWSER](#)

updated 5. 7. 2024 | published 5. 7. 2024

## Summary

Prusa XL series: Front Nozzle (For this nozzle brush, standard 175mm brass wire)

---

[3D Printers](#) > [Prusa Parts & Upgrades](#)

---

Adaptation des brosses laiton de [@Alvomane](#), sur le model de [@Surfalex2000](#)

## This remix is based on



**Prusa XL nozzle brush scrubber with twist lock | Prusa  
XL-Düsenbürste mit Twist Lock**

by [Alvomane](#)



## Prusa XL series: Front Nozzle scrubber (including G-code)

by Surfalex2000

## Model files

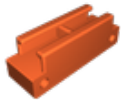

**prusa-xl-nozzle-double-brush-avant.3mf**



**front-nozzle-brush-for-gcode-headbed-mount.3mf**

## License ©



This work is licensed under a  
[Creative Commons \(4.0 International License\)](#)

**Attribution—Noncommercial—Share Alike**

- 
- ✗ | Sharing without ATTRIBUTION
  - ✓ | Remix Culture allowed
  - ✗ | Commercial Use
  - ✗ | Free Cultural Works
  - ✗ | Meets Open Definition