

DE Safety razor holder



Miika

[VIEW IN BROWSER](#)

updated 1. 4. 2024 | published 1. 4. 2024

Summary

Wall-mounted DE safety razor holder. Use double-sided tape to attach to a surface.



2.80 hrs



1 pcs



0.10 mm



0.40 mm



PET



16 g



Prusa MINI /
MINI+

[Household](#) > [Bathroom](#)

Tags: [parker](#) [wallmount](#) [razor](#) [de](#) [shaving](#) [safetyrazor](#)
[muhle](#) [safetyrazorholder](#)

Tested successfully with Parker Variant Adjustable and Mühle RYTMO R220 SR.

Model files

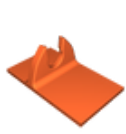



razor_holder.3mf

Print files



razor_holder_04n_01mm_petg_mini_2h48m.bgcode

 PET  0.40 mm  0.10 mm  2.80 hrs  16 g  Prusa MINI / MINI+

License

This work is licensed under a
[Creative Commons \(4.0 International License\)](#)



Attribution-NonCommercial

-
- ✗ | Sharing without ATTRIBUTION
 - ✓ | Remix Culture allowed
 - ✗ | Commercial Use
 - ✗ | Free Cultural Works
 - ✗ | Meets Open Definition