



Strong mug holder



icepower

[VIEW IN BROWSER](#)

updated 2. 4. 2024 | published 2. 4. 2024

Summary

A stronger mug holder to fix to your desk or table. To print without support.

[Household](#) > [Office](#)

Tags: [mugholder](#) [mug](#) [coffeemug](#)

A stronger mug holder to fix to your desk or table. Compatible with table thickness from 5mm to 49mm. To print without support (you can position the clamp like in the last picture to have easy to print bridges). Use 4 perimeter walls to have stronger parts. You need to print the screw twice.

Model files



[mug-holder-clamp.stl](#)



[mug-holder-mug-holder.stl](#)

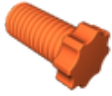

mug-holder-screw.stl

License ©

This work is licensed under a
[Creative Commons \(4.0 International License\)](#)



Attribution—Noncommercial—Share Alike

- ✗ | Sharing without ATTRIBUTION
- ✓ | Remix Culture allowed
- ✗ | Commercial Use
- ✗ | Free Cultural Works
- ✗ | Meets Open Definition