

Carburetor float level gauge



Gixxer

[VIEW IN BROWSER](#)

updated 29. 6. 2024 | published 29. 6. 2024

Summary

A tool for float adjustments.

[Hobby & Makers](#) > [Automotive](#)

Tags: [motor](#) [float](#) [measure](#) [balance](#) [level](#) [adjustment](#) [adjustable](#) [adjust](#) [equal](#) [sync](#) [motorcycles](#) [gas](#) [moto](#) [alcohol](#) [motorcycle](#) [leveling](#) [measuring](#) [leveler](#) [levelling](#) [adjuster](#) [gasoline](#) [measurementdevice](#) [motorsport](#) [measuringtool](#) [alcohol](#) [carburetor](#) [gokart](#) [ethanol](#) [gokarts](#)

I lost my original carburetor adjustment gauge. After seeing a tool I purchased for \$4 dollars twenty years ago is now \$20 I decided to print one. This isn't my idea or design but is the most popular type of tool on the market. It's accurate and prints in 45 minutes with a .4 nozzle at .2 layer height. The fine increments wouldn't print with a .6 nozzle. Support is needed for the ruler part of this and I recommend using tree supports they left a better finish, the parts ultimately slide on each other. Every tab will protrude out the back side by 2.5 mm. Simply lay the tool on a flat heat resistant surface and use a soldering iron to melt the tab flush. I also

recommend slightly melting the sides as well to make the tool more stiff and easier to use.

To use.

Adjust the arms to the width of your carburetor bowl. Place the tool over your floats highest point while resting on the needle valve at a 45 degree angle. Slide the slider down to touch the floats high point and read your measurement.

Model files



carburetor-float-level-gauge-slider.stl

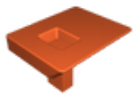

carburetor-float-level-gauge-adjustable-support-1.stl



carburetor-float-level-gauge-back-plate.stl

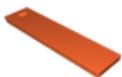

carburetor-float-level-gauge-adjustable-support-2.stl

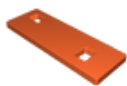

carburetor-float-level-gauge-back-plate-2.stl



carburetor-float-level-gauge-ruler.stl



carburetor-float-level-gauge-arm.stl



carburetor-float-level-gauge-back-plate-2.3mf



carburetor-float-level-gauge-slider.3mf



carburetor-float-level-gauge-adjustable-support-1.3mf



carburetor-float-level-gauge-adjustable-support-2.3mf



carburetor-float-level-gauge-back-plate.3mf



carburetor-float-level-gauge-arm.3mf



carburetor-float-level-gauge-ruler.3mf

License

This work is licensed under a
[Creative Commons \(International License\)](#)

Public Domain



✓ | Sharing without ATTRIBUTION

- ✓ | Remix Culture allowed
- ✓ | Commercial Use
- ✓ | Free Cultural Works
- ✓ | Meets Open Definition