

String Furniture desk back bar bracket

[VIEW IN BROWSER](#)

updated 2. 4. 2024 | published 2. 4. 2024

Summary

Keep the desk back bar into place

[Household](#) > [Living Room](#)

Tags: [stringsystem](#) [stringfurniture](#)

When putting a String Furniture desk shelf on the highest layer of your panel, the back bar will not be able to clamp to anything.

By using this bracket and adding a little bit of felt in between, it will add some friction to keep the bar into place.

I've printed it fully solid to keep the friction, add some extra felt if it is too loose. For me, 2x 0,5mm worked.

Model files



[stringfurnituredeskbracketleft.stl](#)

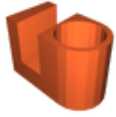

stringfurnituredeskbracketright.stl

License ©

This work is licensed under a
[Creative Commons \(4.0 International License\)](#)



Attribution

- ✗ | Sharing without ATTRIBUTION
- ✓ | Remix Culture allowed
- ✓ | Commercial Use
- ✓ | Free Cultural Works
- ✓ | Meets Open Definition