



TILES: Geometric Tiles for Jewelry & More



sophywong

[VIEW IN BROWSER](#)

updated 11. 4. 2024 | published 11. 4. 2024

Summary

Print TILES, make jewelry!

[Fashion](#) > [Other Fashion Accessories](#)

Tags: [beads](#) [jewelry](#) [geometric](#) [fashion](#) [modern](#) [bracelet](#)
[necklace](#) [thingiverse](#) [bauhaus](#)

TILES is a system I designed for easily making two-color 3D printed jewelry and other wearable accessories. The system is built on a basic rectangular tile, with 6 different surface designs that can be mixed to make any design you like. There are also circular beads and a skinny bar which can be used for adding negative space or just breaking up the rectangles in your design.

The idea is that you can print some of the tiles, all of the tiles, or even just one tile several times, to make bracelets, necklaces, earrings, or anything really. Print a bunch and make a belt, or a headband, or straps for a dress. Some of the surface shapes align across the tiles, and some are standalone shapes. Each tile has two holes for stringing cord or elastic through, and there are access holes on the backside for hiding the knots.

To achieve two colors easily, I designed all of the raised details on the surface to start at 6mm height. Simply start the print with your base color,

and change the filament to the contrast color at 6mm (layer 30 if you are printing at 0.2mm layer height). For convenience, I made two heights for the round beads so that you can print two colors of beads at the same time. The shorter bead will print in just the base color, and the taller bead will be finished with the contrast color on its top layers.

Print Settings

Printer Brand:

Artillery

Printer:

Artillery Sidewinder X2

Rafts:

No

Supports:

No

Resolution:

.02 mm

Notes:

For two colors: change filament at 6mm height (layer 30 if printing at 0.2 mm layer height)

Category: Fashion

Model files

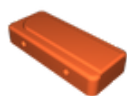

tile_arch_filled.stl

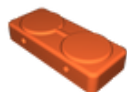

tile_barbell.stl

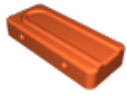

tile_arch_line.stl

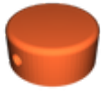

circle_bead_short.stl

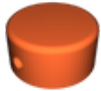

circle_bead_tall.stl

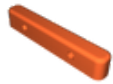

tile_bar.stl

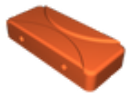

tile_crescents.stl

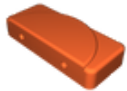

tile_half_moon.stl

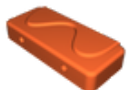

tile_squiggle.stl

[Find source .stl files on Thingiverse.com](https://www.thingiverse.com)

License ©

This work is licensed under a
Creative Commons (4.0 International License)



Attribution—Noncommercial—Share Alike

- ✗ | Sharing without ATTRIBUTION
- ✓ | Remix Culture allowed
- ✗ | Commercial Use
- ✗ | Free Cultural Works
- ✗ | Meets Open Definition