

Ryobi one+ router angled bases



Mark.uofu

[VIEW IN BROWSER](#)

updated 6. 4. 2024 | published 6. 4. 2024

Summary

A collection of angled base from 5-45 degrees for the Ryobi one+ routers

[Hobby & Makers](#) > [Tools](#)

Tags: [router](#) [oneplus](#) [ryobi](#) [ryobi18v](#) [ryobibattery](#) [ryobione](#) [routertable](#) [ryobimount](#) [routerbase](#) [routerjig](#) [routerlift](#) [routerattachment](#) [ryobirouter](#)

This remix changes the angle of the base for the Ryobi one+ router. It includes angles 5-45 degrees and will screw onto the base of the router in place of the factory base. This is a great way to get angled dados and rabbits cut in your projects. With no angle above 45 degree these should print without supports though make sure you set up the prints for your individual printers. I oriented each model to be flat on the print bed so orientation should already be set for you.

This remix is based on

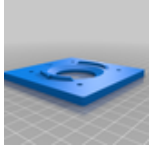

Ryobi Router One+ Base

by Hans Sep

Model files



ryobi_one_18v_router_base-5-deg-base-v2.stl



ryobi_one_18v_router_base-10-deg-base-v2.stl



ryobi_one_18v_router_base-15-deg-base-v2.stl

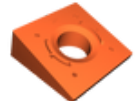

ryobi_one_18v_router_base-20-deg-base-v2.stl



ryobi_one_18v_router_base-25-deg-base-v2.stl



ryobi_one_18v_router_base-30-deg-base-v2.stl



ryobi_one_18v_router_base-35-deg-base-v2.stl

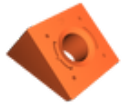

ryobi_one_18v_router_base-40-deg-base-v2.stl

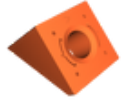

ryobi_one_18v_router_base-45-deg-base-v2.stl

License

This work is licensed under a
[Creative Commons \(4.0 International License\)](https://creativecommons.org/licenses/by-nc/4.0/)



Attribution-NonCommercial

-
- ✗ | Sharing without ATTRIBUTION
 - ✓ | Remix Culture allowed
 - ✗ | Commercial Use
 - ✗ | Free Cultural Works
 - ✗ | Meets Open Definition