

## Benchywreck



Nachman Bayever

[VIEW IN BROWSER](#)

updated 3. 4. 2024 | published 3. 4. 2024

## Summary

An aquarium decoration.

[Household](#) > [Pets](#)

Tags: [thingiverse](#)

I needed to decorate the aquarium at our science center, and I wanted it to represent other facets of the organization. This represents our 3d printing classes, while still looking like a fish tank shipwreck. I had to bury the base in gravel to keep it from floating.

## This remix is based on

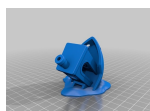

**Half Benchy**

by gyorgyattila

# Model files



**benchywreck.stl**

[Find source .stl files on Thingiverse.com](#)

## License

This work is licensed under a  
**Creative Commons (4.0 International License)**



**Attribution-ShareAlike**

- 
- ✗ | Sharing without ATTRIBUTION
  - ✓ | Remix Culture allowed
  - ✓ | Commercial Use
  - ✓ | Free Cultural Works
  - ✓ | Meets Open Definition