

## Circuit Breaker Latch / Zápádka jističe SEZ

 Tvorim3D

[VIEW IN BROWSER](#)

updated 5. 11. 2023 | published 5. 11. 2023

## Summary

Replacement circuit breaker latch from Slovak manufacturer SEZ.

[Hobby & Makers](#) > [Mechanical Parts](#)

Tags: [latch](#) [sparepart](#) [nahradnidil](#) [jistic](#) [zapadka](#)  
[circuitbreaker](#)

Normally, a circuit breaker latch is unlikely to be lost or broken, but anything is possible...

This spare part will find its application especially in secondary vocational schools focused on electrical engineering, where students use components such as circuit breakers repeatedly in practice work and thus risk damaging them. Fixing the circuit breaker to a DIN rail is then not possible and it would be a shame to throw it away or not use it because of banality.

I recommend printing the model with the supports provided. Infill: grid, min. 50%; number of perimeters: 3; layer height: 0.1 mm or lower.

# Model files

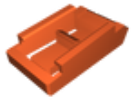

**latch.stl**

☐ without supports

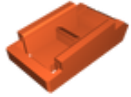

**latch\_with\_supports.stl**

☐ with prepared supports

## License ©

This work is licensed under a  
[Creative Commons \(4.0 International License\)](#)



**Attribution-NonCommercial**

- 
- ✗ | Sharing without ATTRIBUTION
  - ✓ | Remix Culture allowed
  - ✗ | Commercial Use
  - ✗ | Free Cultural Works
  - ✗ | Meets Open Definition