

## Articulating MK4 camera mount arm

 **anstein**

[VIEW IN BROWSER](#)

updated 3. 4. 2024 | published 3. 4. 2024

### Summary

A clip on arm for the articulating camera mount fitting a Tukkari TF enclosure

[3D Printers](#) > [Prusa Parts & Upgrades](#)

Tags: [camera](#) [arm](#) [tf](#) [articulating](#) [mk4](#) [tukkari](#)

This arm can be clipped on a MK4 and be used in combination with the [articulating camera mount parts](#) as well as my [POE camera adapter](#). It fits in a Tukkari TF enclosure.

Designed to be useable in combination with my [lights holder](#).

To be sure to be able to use the complete build height of the MK4 you should print and install the optional support (see red box in above image). Otherwise the movable Z-axis parts may collide with the arm for the last few millimeters of build height.

### This remix is based on



## Spool holder for Original Prusa MK4

by Prusa Research



## Articulating Raspberry Pi Camera Mount for Prusa MK3 and MK2

by Sneaks

## Model files



### Components

3 files

arm.scad

arm.stl



clamp.stl

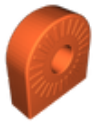

camarm.stl



camarm.3mf



support.stl





support.3mf

## License ©

This work is licensed under a  
GNU



General Public License v2.0

---

- ✗ | Sharing without ATTRIBUTION
- ✓ | Remix Culture allowed
- ✓ | Commercial Use
- ✓ | Meets Open Definition
- i | Share under the same license