

# Airbus A320 Rudder Trim Mechanism



MANTOGA

[VIEW IN BROWSER](#)

updated 4. 4. 2024 | published 4. 4. 2024

## Summary

Realistic 30 degree sprung return rudder trim mechanism using microswitches

[Hobby & Makers](#) > [Mechanical Parts](#)

Tags: [airbus](#) [a320](#) [homecockpit](#)

Mechanism to create realistic 30 degree sprung movement for rudder trim knob. Works with pair of microswitches.

Designed to work with my Rudder Trim Knob:

[Airbus A320 Rudder Trim Knob by MANTOGA | Download free STL model | Printables.com](#)

Design is spaced away from panel to allow backlighting

Base and Top Cover can be printed in PLA, 50% infill. Cam Arm, Cam Actuators and Lower Shaft Clamp printed in PETG, 100% infill for strength.

Additional Parts required:

6mm Brass rod, 120mm length

(3) 12mm OD x 6mm ID x 4mm Thickness Sealed Bearings

8mm diam x 30mm extension spring

M3 and M4 Cap Head Hex screws

M3 Grub screws

(2) 20mm x 11mm Microswitches

## Model files

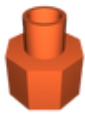

**rudder-trim-mechanism-ma16-lower-shaft-clamp.stl**

---



**rudder-trim-mechanism-ma16-cam-arm.stl**

---

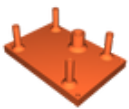

**rudder-trim-mechanism-ma16-top-cover.stl**

---



**rudder-trim-mechanism-ma16-cam-actuator.stl**

---



**rudder-trim-mechanism-ma16-base.stl**

## License

This work is licensed under a  
[Creative Commons \(4.0 International License\)](https://creativecommons.org/licenses/by-nc-sa/4.0/)



**Attribution—Noncommercial—Share Alike**

---

- ✗ | Sharing without ATTRIBUTION
- ✓ | Remix Culture allowed
- ✗ | Commercial Use
- ✗ | Free Cultural Works
- ✗ | Meets Open Definition