



## Spool holder 3 kg



Anton Dziuin

[VIEW IN BROWSER](#)

updated 3. 4. 2024 | published 3. 4. 2024

## Summary

External spool holder

[3D Printers](#) > [Accessories](#)

Tags: [spool](#) [holder](#)

External spool holder. Can fit spools with internal diameter more than 50mm. Require 8x22x7mm bearings, but it works without.

Spool specs requirements:

Internal diameter > 50mm

External diameter < 300mm

Width < 107mm

Axis require simple assembly, just press it in spool's axis bridge hole at the bottom side (rel printing position)

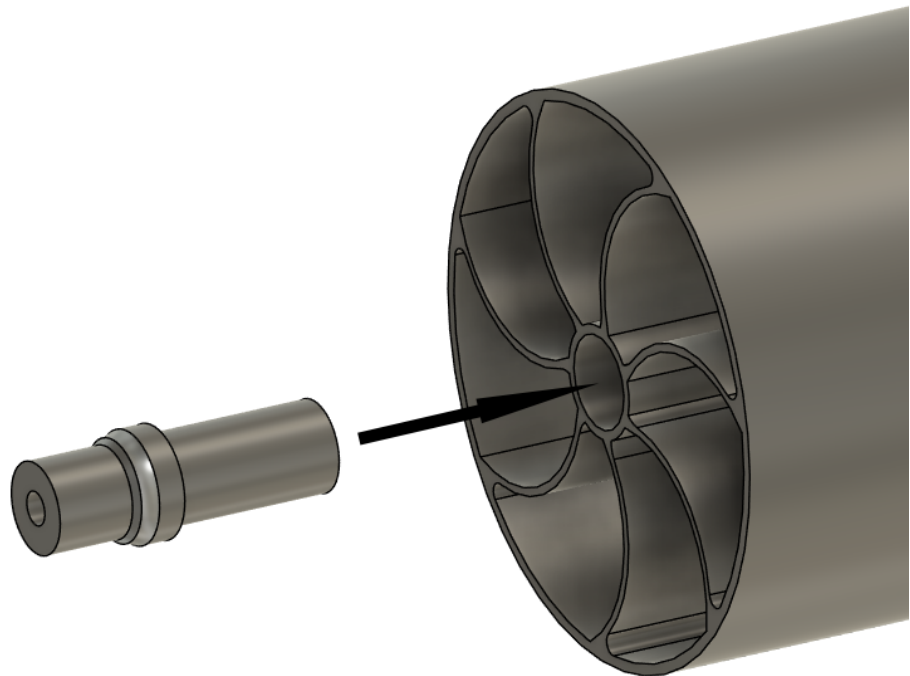

Printing settings:

0.2mm layers

4 walls

4 layers top\bottom

Infill 30% cubic

Brim - preferably for axis parts. I printed with 5mm outer

# Model files



**spool\_holder.stl**



**spool\_axis.stl**



**spool\_axis\_part\_2.stl**

## License ©

This work is licensed under a  
[Creative Commons \(4.0 International License\)](#)



**Attribution-NonCommercial**

- 
- ✗ | Sharing without ATTRIBUTION
  - ✓ | Remix Culture allowed
  - ✗ | Commercial Use
  - ✗ | Free Cultural Works
  - ✗ | Meets Open Definition