

The Darksaber



CaseStudyno8

[VIEW IN BROWSER](#)

updated 8. 5. 2024 | published 8. 5. 2024

Summary

Tarre Vizsla's Darksaber! An ancient and unique lightsaber and symbol of power for the Mandalorians. Much like Kylo...

[Costumes & Accessories](#) > [Props](#)

Tags: [mandalorian](#) [starwarsrebels](#) [thingiverse](#) [darksaber](#)

Tarre Vizsla's Darksaber! An ancient and unique lightsaber and symbol of power for the Mandalorians.

Much like Kylo Ren's Lightsaber, I designed this hilt with more of the overall form in mind rather than how it would be broken apart to avoid a gigantic assembly with too many part lines. Personally, I printed the Emitter Guard with support generated in Cura, depending on how well your printer handles gaps, you may not need that.

Category: Props

Model files

[large_display_darksaber_-_lower_grip_870154.stl](#)

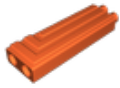

darksaber_-_upper_grip.stl

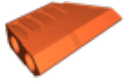

darksaber_-_emitter.stl

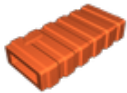

darksaber_-_lower_grip.stl



darksaber_-_emitter_guard.stl

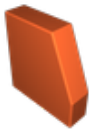

darksaber_-_pommel.stl

[Find source .stl files on Thingiverse.com](#)

License ©

This work is licensed under a
Creative Commons (4.0 International License)



Attribution-NonCommercial

-
- ✗ | Sharing without ATTRIBUTION
 - ✓ | Remix Culture allowed
 - ✗ | Commercial Use
 - ✗ | Free Cultural Works
 - ✗ | Meets Open Definition