

Zmorph FAB buildplate plugin cover



T-MAN

[VIEW IN BROWSER](#)

updated 18. 12. 2021 | published 19. 11. 2021

Summary

I made this cover to protect the build plate cover on the Zmorph Fab from dust and debris while using the CNC toolhead.



0.44 hrs



1 pcs



0.20 mm



0.40 mm



PLA



4 g



Prusa
MK3S/S+ &
MMU2S

[3D Printers](#) > [3D Printers - Upgrades](#)

Tags: [cnc](#) [tman](#) [zmorph](#) [thisisasuperlongtagthatiwrote](#)

Super simple print that is able to be printed with the Prusa MMU or (I think) with the dual extrusion toolhead on the Zmorph Fab. I also included a single material version :).

Model files

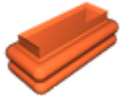

cnc_cover_mmu.stl

📄 MMU part 1



cnc.stl

📄 MMU part 2

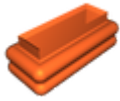

cnc_cover_mmu.3mf

📄 Part 1 & 2 joined together.

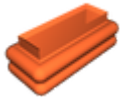

cnc_cover_single.stl

Print files



cnc_cover_02mm_pla_mk3smmu2s_27m.gcode

🌀 PLA 📏 0.40 mm 📏 0.20 mm ⌚ 0.44 hrs ⚖️ 4 g

📄 Prusa MK3S/S+ & MMU2S

License ©

This work is licensed under a
[Creative Commons \(4.0 International License\)](https://creativecommons.org/licenses/by-nc/4.0/)



Attribution-NonCommercial

- ✗ | Sharing without ATTRIBUTION
- ✓ | Remix Culture allowed
- ✗ | Commercial Use

- ✖ | Free Cultural Works
- ✖ | Meets Open Definition