

Count Dooku's Lightsaber



CaseStudyno8

[VIEW IN BROWSER](#)

updated 8. 5. 2024 | published 8. 5. 2024

Summary

Count Dooku's Lightsaber! An interesting hilt to model and print for sure. There is a separate connector piece between...

[Costumes & Accessories](#) > [Props](#)

Tags: [darth](#) [starwars](#) [sith](#) [lightsaber](#) [thingiverse](#)
[lightsabers](#) [count](#) [sithlord](#) [lightsaberstarwars](#)
[revengeofthesith](#) [revengeofsith](#) [dooku](#) [darthtyrannus](#)
[tyrannus](#)

Count Dooku's Lightsaber! An interesting hilt to model and print for sure. There is a separate connector piece between the Emitter and Outer Grip so those two pieces could have a better print orientation. Personally, I printed the emitter and the Outer Grip with support generated from Cura.

Enjoy!

Category: Props

Model files



dooku_-_outer_grip.stl



dooku_-_lower_button_bolt.stl

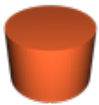

dooku_-_connector.stl



dooku_-_inner_grip.stl



dooku_-_red_trigger.stl



dooku_-_lower_button.stl



dooku_-_emitter_guard.stl



dooku_-_emitter.stl



dooku_-_pommel.stl

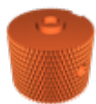

dooku_-_lower_knurled_chamber.stl



dooku_-_lower_curve_transition.stl



dooku_-_upper_trigger.stl

[Find source .stl files on Thingiverse.com](#)

License ©



This work is licensed under a
[Creative Commons \(4.0 International License\)](#)

Attribution-NonCommercial

- ✖ | Sharing without ATTRIBUTION
- ✓ | Remix Culture allowed
- ✖ | Commercial Use
- ✖ | Free Cultural Works
- ✖ | Meets Open Definition