

## Obi-Wan Kenobi's Lightsaber (Episodes I & II)



CaseStudyno8

[VIEW IN BROWSER](#)

updated 8. 5. 2024 | published 8. 5. 2024

### Summary

Here's Obi-Wan Kenobi's Lightsaber from Episodes I & II. I tried to tighten up my tolerances a little with this one so...

[Costumes & Accessories](#) > [Props](#)

Tags: [starwars](#) [cosplay](#) [props](#) [lightsaber](#) [thingiverse](#)  
[obiwankenobi](#) [obiwan](#)

Here's Obi-Wan Kenobi's Lightsaber from Episodes I & II. I tried to tighten up my tolerances a little with this one so let me know if you have any issues with fit. Be sure to print six of the Pommel Blocks for the bottom!

View some process at <http://imgur.com/gallery/IOCyM/>

### Print Settings

#### Rafts:

Doesn't Matter

#### Supports:

Doesn't Matter

Category: Props

## Model files



**ep1\_obi\_wan\_lightsaber\_-\_grip.stl**

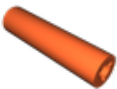

**ep1\_obi\_wan\_lightsaber\_-\_inner\_grip\_rod.stl**



**ep1\_obi\_wan\_lightsaber\_-\_pommel\_block.stl**



**ep1\_obi\_wan\_lightsaber\_-\_lower\_button\_outer.stl**



**d\_ring.stl**

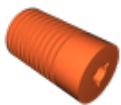

**ep1\_obi\_wan\_lightsaber\_-\_top\_inner\_chamber.stl**



**block\_for\_d-ring.stl**



**ep1\_obi\_wan\_lightsaber\_-\_pommel.stl**



ep1\_obi\_wan\_lightsaber\_-\_lower\_button\_inner.stl

---



ep1\_obi\_wan\_lightsaber\_-\_top\_outer\_shell.stl

---



ep1\_obi\_wan\_lightsaber\_-\_upper\_button.stl

---

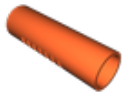

ep1\_obi\_wan\_lightsaber\_-\_inner\_grip.stl

---

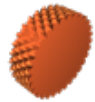

ep1\_obi\_wan\_lightsaber\_-\_on\_off\_button.stl

[Find source .stl files on Thingiverse.com](https://www.thingiverse.com/thing:1000000)

## License ©



This work is licensed under a  
**Creative Commons (4.0 International License)**

**Attribution-NonCommercial**

---

- ✗ | Sharing without ATTRIBUTION
- ✓ | Remix Culture allowed
- ✗ | Commercial Use
- ✗ | Free Cultural Works
- ✗ | Meets Open Definition