



Backup Camera holder for Type S 6.8" touch monitor



Seanoob

[VIEW IN BROWSER](#)

updated 6. 5. 2024 | published 6. 5. 2024

Summary

Holder made to perfectly snap fit over the contours of this Type S 6.8" backup camera monitor, to allow for most...

[Hobby & Makers](#) > [Automotive](#)

Tags: [camera](#) [holder](#) [mount](#) [car](#) [safety](#) [monitor](#)
[thingiverse](#)

Holder made to perfectly snap fit over the contours of this Type S 6.8" backup camera monitor, to allow for most phone holders to grab the device.

I printed it in PLA and it was a strong snap fit, but other filaments may work better.

Category: Automotive

Model files

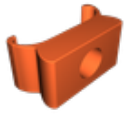

backupcam.stl

[Find source .stl files on Thingiverse.com](#)

License

This work is licensed under a
Creative Commons (4.0 International License)



Attribution-ShareAlike

-
- ✗ | Sharing without ATTRIBUTION
 - ✓ | Remix Culture allowed
 - ✓ | Commercial Use
 - ✓ | Free Cultural Works
 - ✓ | Meets Open Definition