

Formula 1 - Red Bull Ring LED Lamp

 **Boni26_3D**

[VIEW IN BROWSER](#)

updated 8. 5. 2024 | published 8. 5. 2024

Summary

Red Bull Ring wall mounted led lamp easy print

[Art & Design](#) > [Wall-mounted](#)

Tags: [formula1](#) [f1](#) [ledlamp](#) [redbull](#)

Red Bull Ring LED Lamp. Print base with 60% or more infill for the top part 80% or more is preferred to work as a diffuser if needed. Top can be printed with white filament I recommend doing it it a clear filament to let light pass thru better also flip the model so it is facing down when printing the top. To assemble just follow the arrows, use super glue or fuse with more filament. There is no pre-made hole for the LED wires so you can place it wherever you want it can be done with a rotating tool or a soldering iron. To mount on wall 4 pieces with premade holes are available each specific to a corner of the track. It fits LED strips up to 12 mm thick.

Model files



Red_Bull_Ring_Top

8 files



top_part_2.stl



top_part_5.stl



top_part_3.stl



top_part_4.stl



top_part_1.stl



top_part_6.stl



top_part_8.stl



top_part_7.stl



Red_Bull_Ring_Base

8 files



base_part_4.stl



base_part_8.stl



base_part_1.stl



base_part_7.stl



base_part_2.stl

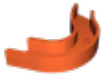

base_part_5.stl



base_part_6.stl



base_part_3.stl



part_4_mount.stl



part_7_mount.stl



part_1_mount.stl



part_2_mount.stl

License



This work is licensed under a
[Creative Commons \(4.0 International License\)](https://creativecommons.org/licenses/by-nc-sa/4.0/)

Attribution—Noncommercial—Share Alike

-
- ✗ | Sharing without ATTRIBUTION
 - ✓ | Remix Culture allowed
 - ✗ | Commercial Use
 - ✗ | Free Cultural Works
 - ✗ | Meets Open Definition