

EL-Car charger holder

S Snipez3.0

[VIEW IN BROWSER](#)

updated 12. 7. 2024 | published 12. 7. 2024

Summary

A holder for a charger to an EL-Car



2.01 hrs



1 pcs



0.20 mm



0.40 mm



PLA



78 g



Prusa MK4

[Art & Design](#) > [Wall-mounted](#)

Tags: [holder](#) [car](#) [charger](#)

A holder for a charger to an EL-Car

Model files

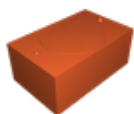

el-bil-lader-holder.3mf

Print files



el-bil-lader-holder.bgcode

PLA 0.40 mm 0.20 mm 2.01 hrs 78 g Prusa MK4

License

This work is licensed under a
[Creative Commons \(International License\)](#)



Public Domain

-
- ✓ | Sharing without ATTRIBUTION
 - ✓ | Remix Culture allowed
 - ✓ | Commercial Use
 - ✓ | Free Cultural Works
 - ✓ | Meets Open Definition