

3D MODEL ONLY

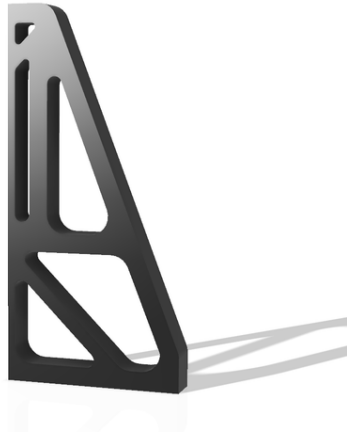

## Modern Bracket



Moose

[VIEW IN BROWSER](#)

updated 13. 7. 2024 | published 13. 7. 2024

## Summary

Just a quick, modern bracket that can be attached using adhesives.

[Hobby & Makers](#) > [Mechanical Parts](#)

Tags: [cute](#) [modular](#) [bracket](#) [modern](#) [nice](#) [pretty](#)  
[newera](#) [bracketholder](#)

This is a modern bracket that can use adhesives to attach to the wall and hold up shelves, or whatever else you want it to! For maximum strength use high infill percentages and strong filaments such as ASA or ABS. I recommend scaling it up to 150% to reach a good strength product.

Happy holding!

## Model files



**bracket.stl**

☐ Print Strong, scale to 150%

## License

This work is licensed under a  
**Creative Commons (4.0 International License)**



**Attribution—Noncommercial—Share Alike**

---

- ✗ | Sharing without ATTRIBUTION
- ✓ | Remix Culture allowed
- ✗ | Commercial Use
- ✗ | Free Cultural Works
- ✗ | Meets Open Definition