



Glock G43 ETS Magazine Baseplate w/ Rail



Brendon

[VIEW IN BROWSER](#)

updated 24. 7. 2024 | published 24. 7. 2024

Summary

Built to fit the Glock G43 ETS magazines, to attach Mantis training system.

[Sports & Outdoor](#) > [Outdoor Sports](#)

I had best results printing vertically with a brim, but, that takes significantly longer. Acceptable prints were made by using supports from print bed only and printing with the rail side on the bed.

- 15% infill
- .15 layer height
- 2 Perimeters

Model files

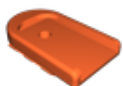

baseplaterail-v2.stl

License ©

This work is licensed under a
Creative Commons (4.0 International License)



Attribution-NonCommercial

- ✗ | Sharing without ATTRIBUTION
- ✓ | Remix Culture allowed
- ✗ | Commercial Use
- ✗ | Free Cultural Works
- ✗ | Meets Open Definition