



Hefty Resmed CPAP Hose Coupler V2



N M

[VIEW IN BROWSER](#)

updated 21. 7. 2024 | published 21. 7. 2024

Summary

Keeps CPAP coupler together while still allowing rotation (AirFit P10 Nasal Pillows Mask connection may fit others)

[Healthcare](#) > [Home Medical Tools](#)

Tags: [cpap](#) [hose](#) [facemask](#) [resmed](#)

Keeps CPAP coupler together to stop middle of the night blasts of air that wake up you and your S.O. when the heater hose uncouples from the mask hose. allows rotation of mask hose for side sleepers that roll over through the night.

PETG works well, I use 100% infill and supports for the smaller diameter ends (designed to print vertically), both rings have a decent flat side at the end with the locking bump. All 4 parts required, though you could print 2 locking half bodies for less rotation when connecting together.

V2: Main Bodies work all good, rings don't positively lock in securely.

V3: <https://www.printables.com/model/949657-hefty-resmed-cpap-hose-coupler-v3>

Model files



resmed-cpap-hose-coupler-that-allows-rotation-body.3mf

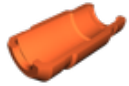

resmed-cpap-hose-coupler-that-allows-rotation-v2-lo... .stl

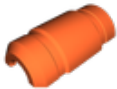

resmed-cpap-hose-coupler-that-allows-rotation-v2-ha... .stl



resmed-cpap-hose-coupler-that-allows-rotation-v2-th... .stl



resmed-cpap-hose-coupler-that-allows-rotation-v2-th... .stl

License

This work is licensed under a
[Creative Commons \(4.0 International License\)](#)



Attribution-NonCommercial

- ✗ | Sharing without ATTRIBUTION
- ✓ | Remix Culture allowed
- ✗ | Commercial Use
- ✗ | Free Cultural Works
- ✗ | Meets Open Definition

