



## IKEA JONAXEL - Vacuum Robot clip-on Bumper (various lenghts)

 **arscreo**

[VIEW IN BROWSER](#)

updated 13. 7. 2024 | published 13. 7. 2024

### Summary

clip-on JONAXEL bumper that prohibits a vacuum robot to try to climb through the shelf feet



2.40 hrs



1 pcs



0.20 mm



0.40 mm



PET



48 g



Prusa MK4

[Household](#) > [Other House Equipment](#)

Tags: [shelf](#) [ikea](#) [robot](#) [dyson](#) [stopper](#) [vacuum](#) [clipon](#) [clips](#) [mijia](#) [shelfbracket](#) [shelfmount](#) [xiaomimijia](#) [roomba](#) [irobot](#) [roborock](#) [dreame](#) [mop](#) [vacuumrobot](#) [switchbot](#) [xiaomivacuum](#) [boundary](#) [jonaxel](#) [shelfsystem](#) [vacuumbot](#) [shelfbumper](#) [boundaries](#)

This bumper was designed specifically for the **80x38x160cm Ikea JONAXEL shelving unit** in order to prohibit our resident Vacuum Robot climbing through the feet (which it can, but not very graciously). **It'll likely work**

**with all other JONAXEL shelf variations.** Once clipped on, it should be tight enough to not move left/right without considerable force.

This clip-on bumper will trigger the vacuum robot tactile sensors, the top edge is going to be **4,5cm** off the ground when installed.



As for which length you print, the **80x38x160cm** shelf feet inner dimension is about 35,1cm - so you could opt to fill up the entire length (e.g. 2x **17,5cm** ), or print one or more smaller ones if you think those will be enough to stop your vacuum. I opted for the 150mm version for aesthetic and filament usage reasons. It's more than sturdy enough for the robot not to be able to move it even with vigorous attempts.

The files include lengths of **16mm, 50mm, 100mm, 150mm, 175mm**, and a **CAP** to close off the ends if you want to.

I've included a **.STEP** file with proper polysurface geometry in case you want to make adaptations.

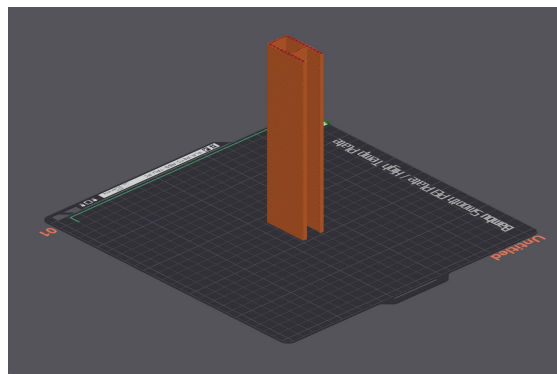

**Print direction:** vertical. Print adhesion with **PETG** and a clean smooth plate was more than strong enough for me to print up the **150mm version without any brim**, for longer versions you'll have to decide on your own. No supports needed.

# Model files

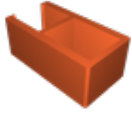

**arscreo\_jonaxel-vacuum-robot-bumper\_16mm.stl**

📄 16mm

---



**arscreo\_jonaxel-vacuum-robot-bumper\_50mm.stl**

📄 50mm

---



**arscreo\_jonaxel-vacuum-robot-bumper\_100mm.stl**

📄 100mm

---



**arscreo\_jonaxel-vacuum-robot-bumper\_150mm.stl**

📄 150mm

---



**arscreo\_jonaxel-vacuum-robot-bumper\_175mm.stl**

📄 175mm

---

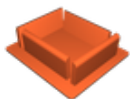

**arscreo\_jonaxel-vacuum-robot-bumper\_cap.stl**

📄 CAP for closing off the bumpers from dust. Print 2 per bumper.

---

**arscreo\_jonaxel-vacuum-robot-bumper\_complete-step-f... .stp**

📄 STEP file containing polysurface geometry of all variants

---

**bambuslicer\_arscreo\_jonaxel-vacuum-robot-bumper.3mf**

📄 3MF file cointaining all variants. No Supports, no Brim.

# Print files



## preview-only-dont-print.bgcode

PET 0.40 mm 0.20 mm 2.40 hrs 48 g Prusa MK4

DO NOT PRINT THIS GCODE

## License



This work is licensed under a  
[Creative Commons \(4.0 International License\)](#)

**Attribution—Noncommercial—Share Alike**

- 
- ✖ | Sharing without ATTRIBUTION
  - ✓ | Remix Culture allowed
  - ✖ | Commercial Use
  - ✖ | Free Cultural Works
  - ✖ | Meets Open Definition