



addons for the diy sequential shifter by BeavisMotorsport



kieran shelley

[VIEW IN BROWSER](#)

updated 13. 7. 2024 | published 13. 7. 2024

Summary

some extra parts and modified parts

[Hobby & Makers](#) > [Other Ideas](#)

This remix is based on



DIY Racing Sim Sequential Shifter
by BeavisMotorsport

Model files



leo-tiny-adapter.stl

☐ for holding a leonardo tiny board from duinotech,

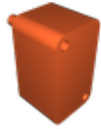

spacer-with-pin-mod-2-l.stl

☐ for using 8 20mm m3 tamiya rc screws, 2.5mm holes for m3 tap



spacer-with-pin-mod-1-r.stl



shiftershaft-for-rc-car-springs.stl

☐ resized recess for larger spring



spring-perch.stl

☐ x2, place over the m10 end stop bolts to capture spring

License

This work is licensed under a
[Creative Commons \(4.0 International License\)](https://creativecommons.org/licenses/by-nc/4.0/)



Attribution-NonCommercial

- ✗ | Sharing without ATTRIBUTION
- ✓ | Remix Culture allowed
- ✗ | Commercial Use
- ✗ | Free Cultural Works
- ✗ | Meets Open Definition

