



## 2-in-1 Case and Stand for ZSUS 2160\*1440 14-inch 2K Portable Monitor

i izl

VIEW IN BROWSER

updated 13. 7. 2024 | published 13. 7. 2024

## Summary

Case that doubles as a tall stand for a cheap portable monitor

[Gadgets](#) > [Computers](#)

Tags: [case](#) [monitor](#) [portablemonitor](#)

CAD: <https://cad.onshape.com/documents/d027dcd4f0171426926daaa8/w/7480ec829498529c98da204a/e/cb4d4768a869bf5ec2df2a6e>

This model can be considered a first prototype of the idea. Although it works well in practice, there are a couple things that can be improved:

- I printed the model in the same orientation as it would stand, but the print quality at the top near the opening suffers since it is essentially a tall thin unsupported wall. It may be better to print in the orientation of the STL and use supports.
- The angle should probably be more vertical, currently it is 75 degrees.
- The case holds together decently due to the alignment features, but a positive lock would be nicer.

- The case takes around 500g in PLA, which seems too much. Should experiment with thinner walls, maybe also ABS/ASA which is less dense. Warping would be an issue (it already noticable with PLA).

## Model files

**screen-case.step**

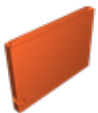

**screen-case-part-1.stl**



**screen-case-part-2.stl**



**screen-case-part-3.stl**



**screen-case-part-4.stl**

## License ©

This work is licensed under a  
**Creative Commons (4.0 International License)**



**Attribution—Noncommercial—Share Alike**

- 
- ✗ | Sharing without ATTRIBUTION
  - ✓ | Remix Culture allowed
  - ✗ | Commercial Use
  - ✗ | Free Cultural Works

✖ | Meets Open Definition