

IKEA JONAXEL - Clip-On HOOK Collection

 arscree

[VIEW IN BROWSER](#)

updated 13. 7. 2024 | published 13. 7. 2024

Summary

Collection containing various hooks in 2 categories. HEAVY-DUTY: only clips on frame, LIGHT-DUTY: frame & shelves.



0.07 hrs



1 pcs



0.20 mm



0.40 mm



PET



1 g



Prusa MK4

[Household](#) > [Other House Equipment](#)

Tags: [shelf](#) [ikea](#) [holder](#) [hook](#) [clip](#) [clapon](#) [collection](#)
[shelves](#) [towelholder](#) [pressfit](#) [towelhook](#) [load](#) [banana](#)
[clipping](#) [jonaxel](#) [loadbearing](#)

These hooks were made for the **IKEA JONAXEL product family** of shelves.

There are two main categories: **HEAVY-DUTY**(only attachable to the **frame**) and **LIGHT-DUTY** (attachable to **either frame or the shelves**).
Examples:

HEAVY-DUTY LIGHT-DUTY



The hooks come with these dimensions:

- **WIDTH** of **4mm** or **16mm** wide
- hook **SPAN** of either **12mm** or **27mm**
- **HOOK** protrusion of either **4mm** or **16mm**
- **normal or extended** (hook **47mm** below frame/shelf top surface)
- special variants (double, two hooks, ...)

MAXIMUM LOADS

As for science, the **smallest light duty version** will top out at **5 bananas**, any more bananas and the hook will fall down (I caught the bananas).



The **heavy duty version** can easily handle **10 bananas**, but **unfortunately I ran out of bananas to properly test it to failure**. By my estimation as experienced banana user, it will easily hold **at least 40 bananas** before hook might slip slightly but still hang on, and probably around **70 bananas** until it completely loses grip.



FILES

I've included a **.STEP file** with proper polysurface geometry so you can adjust them to your needs.

Model files



HEAVY-DUTY (normal)

8 files



heavy-duty_normal_4mmwide_12mmspan_4mmhook.stl



heavy-duty_normal_16mmwide_12mmspan_4mmhook.stl



heavy-duty_normal_4mmwide_27mmspan_4mmhook.stl



heavy-duty_normal_4mmwide_27mmspan_16mmhook.stl

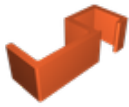

heavy-duty_normal_16mmwide_27mmspan_16mmhook.stl

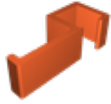

heavy-duty_normal_16mmwide_27mmspan_4mmhook.stl



heavy-duty_normal_16mmwide_12mmspan_16mmhook.stl



heavy-duty_normal_4mmwide_12mmspan_16mmhook.stl



HEAVY-DUTY (extended)

10 files



heavy-duty_extended_16mmwide_27mmspan_4mmhook.stl



heavy-duty_extended_16mmwide_12mmspan_4mmhook_rever... .stl



heavy-duty_extended_16mmwide_12mmspan_16mmhook.stl



heavy-duty_extended_16mmwide_12mmspan_16mmhook_27mm... .stl



heavy-duty_extended_16mmwide_12mmspan_4mmhook.stl



heavy-duty_extended_16mmwide_12mmspan_4mmhook_double .stl



heavy-duty_extended_16mmwide_12mmspan_16mmhook_doub... .stl

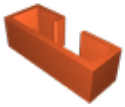

heavy-duty_extended_16mmwide_12mmspan_16mmhook_reve... .stl



heavy-duty_extended_16mmwide_27mmspan_16mmhook.stl



heavy-duty_extended_16mmwide_12mmspan_4mmhook_27mms... .stl



LIGHT-DUTY (normal)

8 files



light-duty_normal_4mmwide_27mmspan_16mmhook.stl



light-duty_normal_4mmwide_27mmspan_4mmhook.stl



light-duty_normal_4mmwide_12mmspan_4mmhook.stl

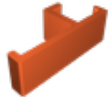

light-duty_normal_16mmwide_27mmspan_4mmhook.stl



light-duty_normal_16mmwide_12mmspan_4mmhook.stl



light-duty_normal_16mmwide_12mmspan_16mmhook.stl



light-duty_normal_16mmwide_27mmspan_16mmhook.stl



light-duty_normal_4mmwide_12mmspan_16mmhook.stl



LIGHT-DUTY (extended)

4 files



light-duty_extended_16mmwide_12mmspan_4mmhook.stl



light-duty_extended_16mmwide_27mmspan_4mmhook.stl



light-duty_extended_16mmwide_27mmspan_16mmhook.stl



light-duty_extended_16mmwide_12mmspan_16mmhook.stl

arscreo_ikea-jonaxel_clip-on-hook-collection.stp

☐ .STEP file, contains all models as proper polysurface geometry for you to easily adapt

bambuslicer_arscreo_ikea-jonaxel_clip-on-hook-colle... .3mf

☐ buildplates containing all models together AND separately

Print files



preview.bgcode

PET 0.40 mm 0.20 mm 0.07 hrs 1 g Prusa MK4

☐ DO NOT PRINT, only for calculations

License ©

This work is licensed under a
Creative Commons (4.0 International License)



Attribution—Noncommercial—Share Alike

✗ | Sharing without ATTRIBUTION

✓ | Remix Culture allowed

- ✖ | Commercial Use
- ✖ | Free Cultural Works
- ✖ | Meets Open Definition