



Filament Rack for 1/2" Wooden Dowel Rods



[VIEW IN BROWSER](#)

updated 15. 7. 2024 | published 15. 7. 2024

Summary

Remix of BTR3D's filament rack that works with far cheaper wooden dowel rods instead of metal tubes.

[3D Printers](#) > [Accessories](#)

Tags: [spool](#) [organizer](#) [filament](#) [3dprinting](#) [spoolholder](#) [easytoprint](#) [storage](#) [spoolmount](#) [easy](#) [accessory](#) [wood](#) [rack](#) [organization](#) [3dprinter](#) [store](#) [organize](#) [3dprint](#) [3dprinterparts](#) [easyprint](#) [easyassembly](#) [3dprinteraccessory](#) [dowel](#) [filamentrack](#)

I fell in love with BTR3D's original filament rack design, but I realized after printing the parts that the recommended 12" metal rods on Amazon were quite expensive at a \$23.38 price point to make just one rack. Switching to 15" wooden dowel rods lowers this to just \$4 per rack based on [this listing](#) I used (not affiliated). You can also purchase significantly longer wooden dowel rods and add the included pass-through design in the middle to make your filament rack longer and sturdier.

Each side of the filament rack prints in two parts so it fits on smaller printers like the A1 mini; you'll need two of each part to make both sides. Supports are needed for the bottom part underneath the inserts.

I included files for small cylindrical “adapters” that can be used if you printed the original rack design to let the wooden dowels fit snugly. If you print the new design with smaller holes then these adapters are not necessary.

I also included alternate files if you just want a single row design instead of the double stacked design. There's a version for 250g mini filament spools if you want to put those on a rack too.

This remix is based on



Filament Rack

by BTR3D

Model files

 **Default** 4 files



side-rack-top.stl
☐ print 2x



side-rack-bottom.stl
☐ print 2x, supports under inserts



middle-rack-top.stl
☐ optional for dowel rod pass through



middle-rack-bottom.stl

☐ optional for dowel rod pass through, supports under inserts



Single Rack

2 files



side-single-rack.stl

☐ print 2x



middle-single-rack.stl

☐ optional for dowel rod pass through



Single Mini Rack

2 files

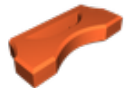

side-mini-single-rack.stl

☐ print 2x



middle-mini-single-rack.stl

☐ optional for dowel rod pass through



original-design-adapter.stl

☐ only needed if you printed BTR3D's original design and want to use wooden dowels

License

This work is licensed under a
Creative Commons (International License)



Public Domain

- ✓ | Sharing without ATTRIBUTION
- ✓ | Remix Culture allowed
- ✓ | Commercial Use
- ✓ | Free Cultural Works
- ✓ | Meets Open Definition