



Ledger Nano Case with Label



Tony

[VIEW IN BROWSER](#)

updated 14. 7. 2024 | published 14. 7. 2024

Summary

The basic advantage of using this model is for a little added protection to Ledger Nano X and ability to label

[Hobby & Makers](#) > [Organizers](#)

Tags: [case](#) [bitcoin](#) [crypto](#) [label](#) [ledger](#) [ledgernanox](#)
[nanox](#)

The basic advantage of using this model is for a little added protection to the outside of your Ledger Nano X and ability to label it. If you are on a Bambu printer, download the print profile from here: <https://makerworld.com/en/models/539514#profileId-456802>

I made this because I needed a way to label my Ledger Nano X's but sharpies did not work on the metal case as the ink whips off. I tried to laser engrave the metal and that did nothing. I ended up making this case and have been pleased with the results in the last few weeks of testing. I figured I would share in case this helps someone else.

I've tested about 10 different variations, from a full body case to a minimal band that wraps around the ledger, I ended up with this design because it worked best with all the Ledger Nano X's that I have. Each Nano X metal case has a slightly different bend in the metal, this design attempts to account for the various minor differences.

I've included a few different variations:

1. Blank - No text / No logo label

Advantages: Print upright, no supports

Disadvantages: No text label, you will need to use a sharpie or label machine to put the label on the side.

Time to print 1 case: 26 minutes - Weight: 5.25g

2. Ledger Case with #1-5 label

Advantages: Has text label on the side with options with numbering from 1 through 5.

Disadvantages: Requires supports (I use tree supports). Supports can be complex to remove, be careful, the case can be fragile. Make sure you fully remove the supports, any little bit left can mess with the final fit. I typically use a razor blade / plate scraper to remove the supports so that's its smooth.

Time to print 1 case: 1 hour 13 mins - Weight: 13.64g

Time to print 4 cases: 3 hours 15 mins - Weight: 34.75g

Print settings

I've been using these settings:

Layer height: .12

Infill: 50% - Gyroid

Walls: 3

Installation

1. Remove the metal casing. This is easy to do, I use two hands and pull each metal side away from the ledger device and it should fall away from the metal casing. Be sure to not let it hit the ground.
2. Slide the 3D printed Ledger Case in place, make sure it fully slides in place, if not check that all support material was removed.
3. Reattach the metal casing to the ledger device. Make sure the case is fully set in place.

Note

- **Only tested on Ledger Nano X - no other devices.**

- Use at your own risk. I'm not accountable for damages. Total testing time is 2 weeks, so far so good.
- I'm somewhat a new model designer so feel free to reach out with any suggestions/comments.

Check me out on other sites: and consider joining my new Patreon account:

<https://www.patreon.com/t0nyz>

<https://makerworld.com/en/@t0nyz>

<https://www.youtube.com/@t0nyz0>

Model files

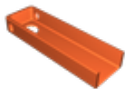

ledger-case-blank.stl

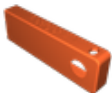

ledger-case-1.stl

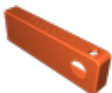

ledger-case-2.stl

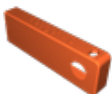

ledger-case-3.stl

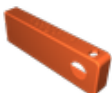

ledger-case-4.stl

License ©

This work is licensed under a
Creative Commons (4.0 International License)



Attribution—Noncommercial—No Derivatives

- ✗ | Sharing without ATTRIBUTION
- ✗ | Remix Culture allowed
- ✗ | Commercial Use
- ✗ | Free Cultural Works
- ✗ | Meets Open Definition