

# Shelly 1PM Mini - DIN Rail Mount



mjonuschat

[VIEW IN BROWSER](#)

updated 14. 7. 2024 | published 14. 7. 2024

## Summary

Space efficient DIN Rails Mount for the Shelly 1PM Mini

[3D Printers](#) > [Voron Parts & Upgrades](#)

Tags: [shelly](#) [dinrail](#) [dinrailmount](#) [voron](#) [powermeter](#)

Simple DIN Rail mount for the Shelly 1PM Mini. DIN Rail clip requires two M3x5x4 (Voron style) Heatset inserts, the Shelly mount can then be attached with M3x8 screws to the clip.

## Model files



[shelly-1pm-mini-din-rail-mount.stl](#)

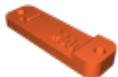

[din-rail-clip.stl](#)

# License

This work is licensed under a  
**GNU**



**General Public License v3.0**

---

- ✗ | Sharing without ATTRIBUTION
- ✓ | Remix Culture allowed
- ✓ | Commercial Use
- ✓ | Meets Open Definition
- i | Share under the same license