

Spool Rack for Bambu Lab A1



MW-Mechanical

[VIEW IN BROWSER](#)

updated 20. 7. 2024 | published 20. 7. 2024

Summary

Holds four 1kg spools! Requires two M4x50 bolts+nuts. PETG and thick walls recommended. Reuses A1 PTFE swivel guide.

[3D Printers](#) > [Bambu Lab Parts & Upgrades](#)

Tags: [spool](#) [holder](#) [filament](#) [extender](#) [ams](#)

Model files



[arm-left.stl](#)



[arm-right.stl](#)



ptfe-guide.stl



bar-male.stl



bar-female.stl

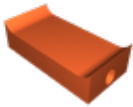

spacer-qty-2.stl

License

This work is licensed under a
[Creative Commons \(4.0 International License\)](https://creativecommons.org/licenses/by-nc-sa/4.0/)



Attribution—Noncommercial—Share Alike

- ✗ | Sharing without ATTRIBUTION
- ✓ | Remix Culture allowed
- ✗ | Commercial Use
- ✗ | Free Cultural Works
- ✗ | Meets Open Definition