

Nissan Patrol Y61 Cupholder



James Br

[VIEW IN BROWSER](#)

updated 14. 7. 2024 | published 14. 7. 2024

Summary

Cup holder for the Nissan Patrol Y61 GU. STL and gcode file attached. You'll have to flip it base down in your slicer.



N/A



1 pcs



N/A



N/A



N/A



N/A



Creality
Ender 3 V3
SE

[Hobby & Makers](#) > [Automotive](#)

Tags: [cupholder](#) [nissan](#) [gu](#) [patrol](#) [y61](#)

A basic cupholder that I made up for my Nissan Patrol Y61 / GU. STL and gcode file attached. I printed in grey PLA and it went ok, but the bottom seemed to shrink and look funny on mine - but you cant see anyway once it is installed. Fix it with screws through the tab bit.

You'll have to flip it base down in your slicer.

Model files

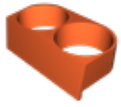

patrolcupholder_brewy_v2.stl

Print files



y61patrol_cphldr_brewy.gcode

License ©



This work is licensed under a
[Creative Commons \(4.0 International License\)](https://creativecommons.org/licenses/by-nc/4.0/)

Attribution-NonCommercial

-
- ✗ | Sharing without ATTRIBUTION
 - ✓ | Remix Culture allowed
 - ✗ | Commercial Use
 - ✗ | Free Cultural Works
 - ✗ | Meets Open Definition