



CNC GRBL 32bits board V2.0 LCD enclosure



Andreas Känner

[VIEW IN BROWSER](#)

updated 25. 7. 2024 | published 25. 7. 2024

Summary

This is my version of a housing for the LCD touch module of the GRBL 32bits board V2.0 from makerfr.com

[Hobby & Makers](#) > [Electronics](#)

You can control a CNC machine using the LCD touch module and the main board. For more information, visit makerfr.com.

This powerful controller offers versatile connectivity options, such as connecting the LCD module to the main board via cable or wirelessly. To accommodate this, I designed a detachable housing with accessible connectors.

Housing Details

The housing consists of two parts: **top.stl/stp** and **bottom.stl/stp**. Both parts can be printed without support, although I used support for the SD card slot on the top part (depends on your print settings). Additionally, **base_plate.stl/stp** can be printed without support.

Assembly Instructions

- **Housing Assembly:**
 - Use four 30mm long wood screws with a diameter of 3mm to hold the two halves together.
- **Magnets:**
 - You need four magnets for the bottom part. Each magnet should be 10mm in diameter and 2mm thick.
 - Glue the magnets into the designated holes with superglue.
- **Base Plate:**
 - Attach four euro cent pieces to the base plate using superglue.

Modifications

If you need to modify the design, all parts are available as STEP files as well.

Model files

bottom.stp

base_plate.stp

top.stp

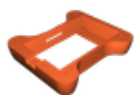

top.stl

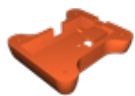

bottom.stl



base_plate.stl

License Θ

This work is licensed under a
Creative Commons (4.0 International License)



Attribution-ShareAlike

- ✗ | Sharing without ATTRIBUTION
- ✓ | Remix Culture allowed
- ✓ | Commercial Use
- ✓ | Free Cultural Works
- ✓ | Meets Open Definition